

GROUP:	3425JC
FORM:	4171-794, Rev. B
FILE:	Alternator Parts List Section
DATE:	July, 1994

PRODUCTS COVERED

MODEL	VOLTS	AMPS
3425JC	12	75
3426JC	24	65
3428JC	24	65
3429JC	32	75
3525JC	12	90
3625JC	12	105
3627JC	24	100
3628JC	24	100
3632JC	32	115
3725JC	12	130

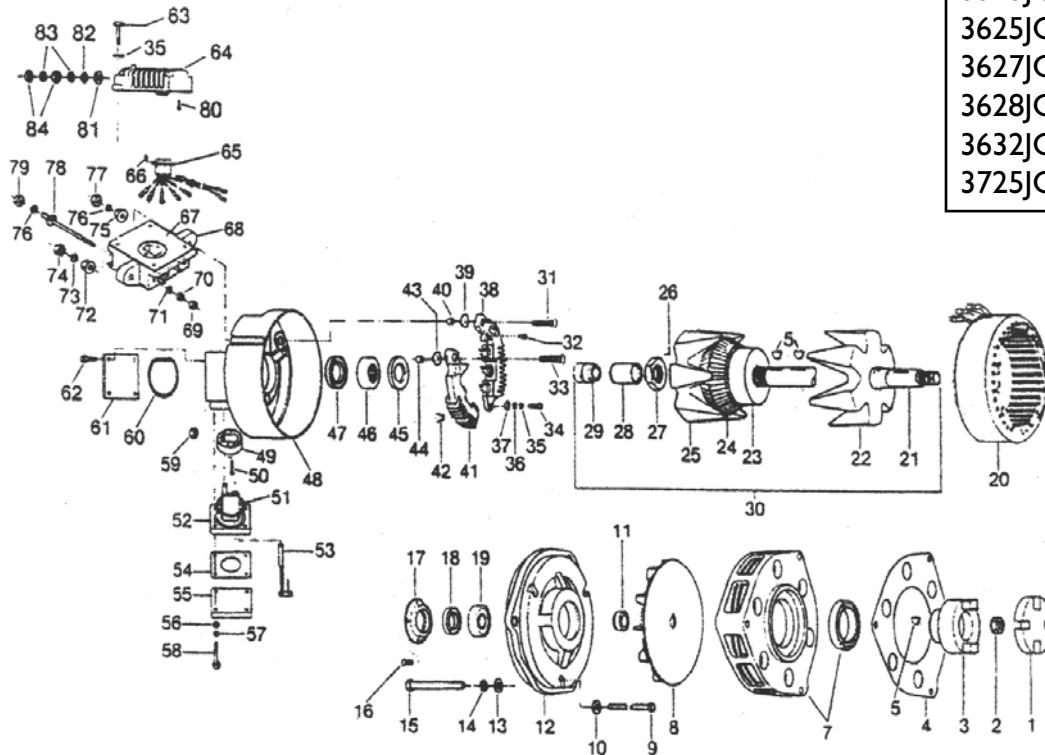

Parts Not Common

Note 1: A quantity of one (1) is used for each item listed below.

Ref. #	20	24	30	38	41	64
Description	Stator	Rotor Coil	Rotor Assy.	Rectifier Assy. (-)	Rectifier Assy. (+)	Regulator
Alternator Part Numbers						
3425JC (12V)	97288	79476	79536	71236	71235	99500
3426JC (24V)	97290	79516	79609	71238	71237	99825
3428JC (24V)	97290	79516	79609	71238	71237	95300
3429JC (32V)	96529	96530	96532	99786	99787	99850
3525JC (12V)	97712	99795	79602	71236	71235	99500
3625JC (12V)	97291	99795	79602	71236	71235	99500
3627JC (24V)	97712	79516	79609	71238	71237	99825
3628JC (24V)	97712	79516	79609	71238	71237	95300
3632JC (32V)	97712	79516	79609	99786	99787	99850
3725JC (12V)	97292	79479	79536	99769	99768	99500

Important: The information contained in this bulletin is intended for use by trained, professional technicians who have the proper tools, equipment, and training to perform the required maintenance described above. This information is NOT intended for 'do-it-yourselfers', and you should not assume that this information applies to your equipment. If you have any questions regarding this information please visit our website at www.prestolite.com, or contact our customer service department at:

Parts Common

GROUP: 3425JC
FORM: 4171-794, Rev. B

Ref. No.	Part No.	Qty.	Description	Ref. No.	Part No.	Qty.	Description
1	99642	1	Coupling, Accessory Drive	46	79406	1	Roller Bearing, 203
2	76985	1	Nut, 5/8 Hex. Fl. Lock	47	79403	1	Oil Seal
3	99640	1	Hub, Accessory Drive	48	99474	1	SRE Housing
4	Note 2	1	Gasket	49	99508	1	Brush Holder Adapter
5	6399	3	Key, Woodruff #8	50	13747	2	Screw, 6-32 x .62 Rd. Hd. St.
7	Note 3	1	Fan Guard & Seal Assembly	51	99514	1	"O" Ring
8	79587	1	Fan	52	99479	1	Brush Holder
9	95152	3	Screw, 10-32 x 5.22	53	99516	2	Brush Assembly
10	79627	3	Guard, Washer	54	99518	1	Gasket
11	79546	1	Fan Spacer	55	99517	1	Brush Cover
12	79535	1	DE Housing	56	36912	4	Guard Washer, #8
13	99645	3	Washer, Flat	57	2435	4	Lockwasher, #8
14	26351	3	Lockwasher, 3/8"	58	99524	4	Screw, 8-32 x 1 Hex Hd. St.
15	99643	3	Mounting Bolt, 3/8-16 3.5 Hex	59	74732	3	Nut, 10-32 Flange Lock
16	58754	4	Screw, 10-32 x .44 Fl. Hd. St.	60	99511	1	"O" Ring
17	79486	1	Bearing Retainer	61	99512	1	Cover Plate
18	79405	1	Oil Seal	62	75348	4	Screw, 10-32 x .50 Hex Hd. St.
19	78895	1	DE Bearing, Ball 305	63	99525	4	Screw, 10-32 x 1 Hex Hd. St.
21	79537	1	Rotor Shaft	65	99481	1	Connector Assembly
22	Note 4	1	DE Rotor Half	66	13771	2	Screw, 4-40 x .25 Rd. Hd. St.
23	75570	1	Rotor Hub	67	99515	1	Regulator Gasket
25	Note 4	1	SRE Rotor Half	68	99478	1	Regulator Holder
26	78047	1	Insulator, Slot	69	31587	3	Nut, 10-32 Hex
27	30806	1	Nut, 1-14 Hex. St.	70	2313	3	Nut, 10-32 Hex
28	79424	1	Inner Race, Bearing	71	79469	3	Guard, Washer
29	71193	1	Slip Ring Assembly	72	73009	1	Nut, Tenz 5/16-18
31	79313	1	Output Terminal Screw, 1/4"	73	3231	1	Lockwasher, 5/16
32	73543	3	Screw, 6-32 Hex. Hd. S'tap	74	2364	1	Nut, 5/16-18 Hex St.
33	78997	1	Output Terminal Screw, 5/16"	75	59982	1	Nut, Tenz 1/4-20
34	78337	2	Screw, 10-32 x .75 Pan Hd. St.	76	2523	4	Lockwasher, 1/4
35	2434	6	Lockwasher, #10	77	2771	1	Nut, Tenz 1/4-20
36	2385	2	Guard Washer #10	78	99513	3	AC Terminal Stud
37	52066	2	Insulation Washer	79	3395	3	Nut, 1/4-20 Hex
39	73545	1	Insulation Bushing	80	99459	1	Screw, 6-32 x 1/4" Pan Hd.
40	79070	1	Insulation Bushing	81	7983	1	Insulation Washer
42	73547	2	Insulation Bushing	82	5413	1	Flat Washer
43	73546	1	Insulation Bushing	83	31256	2	Lockwasher, S'proof
44	79071	1	Insulation Bushing	84	4340	2	Nut, 10-24 Hex
45	79404	1	Oil Seal				

*Suggested Service Parts

NOTE 2: Engine Series 71 & 92 use #101051 gasket; Engine 6V-53 use #99651.

NOTE 3: Engine Series 71 & 92 use #99649 fan guard & seal assembly; Engine 6V-53 use #99650.

NOTE 4: Rotor half replacement is recommended only if accurate machining and balancing equipment is available. Part numbers are available on request from factory.

Form 4171, 7-94

Important: The information contained in this bulletin is intended for use by trained, professional technicians who have the proper tools, equipment, and training to perform the required maintenance described above. This information is NOT intended for 'do-it-yourselfers', and you should not assume that this information applies to your equipment. If you have any questions regarding this information please visit our website at www.prestolite.com, or contact our customer service department at:

Leece-Neville Heavy Duty Systems
7585 Empire Drive
Florence, KY 41042