

GROUP:	4425-4725JC
FORM:	4627, 10/95
FILE:	Alternator Parts List Section
DATE:	October, 1995

PRODUCTS COVERED

MODEL	VOLTS	AMPS
4425JC	14	75
4426JC	28	65
4625JC	14	105
4626JC	28	100
4632JC	37.5	115
4725JC	14	130

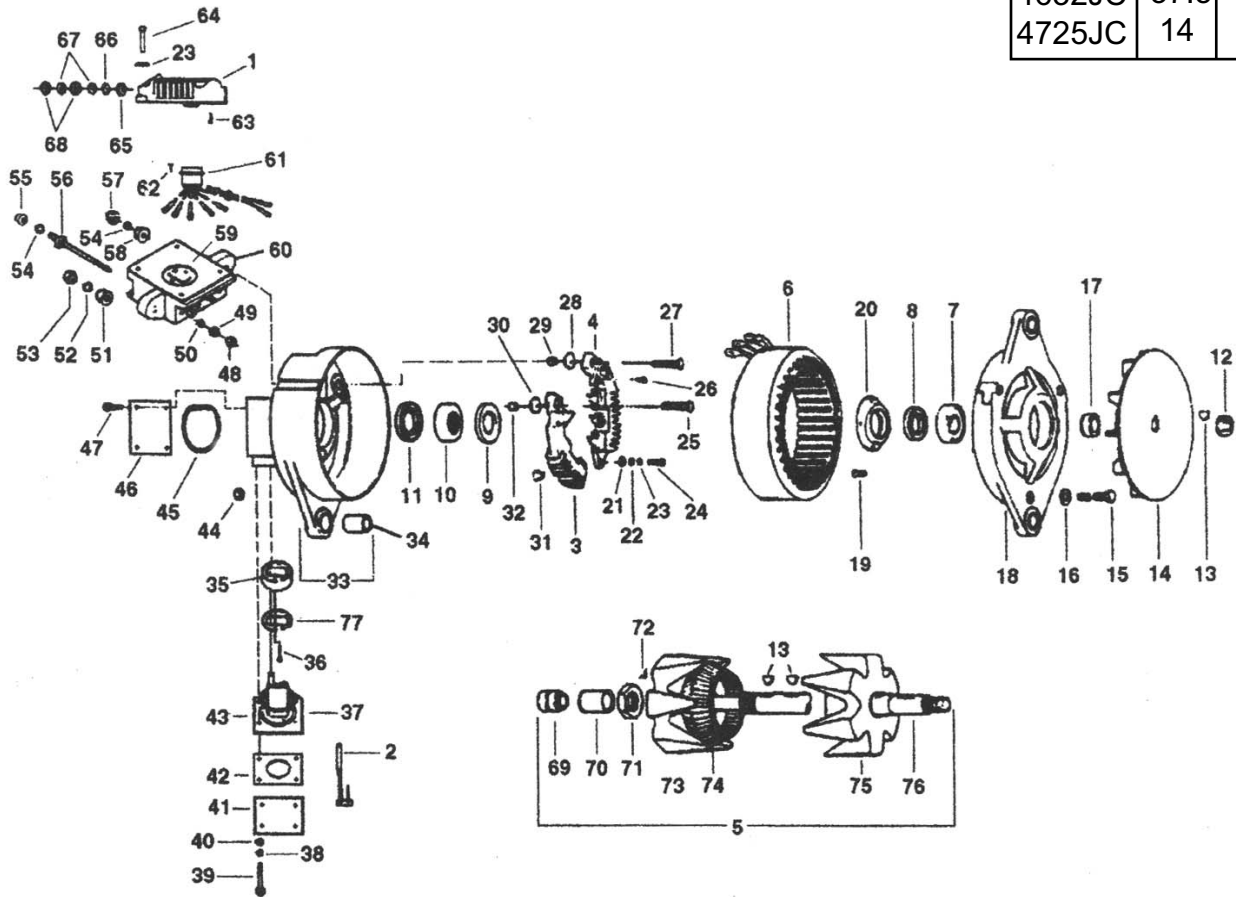

PARTS NOT COMMON

Ref. No.	Qty	Description	4425JC	4426JC	4625JC	4626JC	4632JC	4725JC
1	1	*Regulator	99500	99825	99500	99825	99850	99500
3	1	*Rectifier Assembly, Positive	71237	71237	71237	71237	99787	99768
4	1	*Rectifier Assembly, Negative	71238	71238	71238	71238	99786	99769
5	1	*Rotor Assembly	79501	79517	79501	79517	79517	79501
6	1	*Stator	99504	99793	99790	99789	99789	99794
74	1	*Rotor Coil	79476	79516	79476	79516	79516	79476

*Suggested Service Parts

Important: The information contained in this bulletin is intended for use by trained, professional technicians who have the proper tools, equipment, and training to perform the required maintenance described above. This information is NOT intended for 'do-it-yourselfers', and you should not assume that this information applies to your equipment. If you have any questions regarding this information please visit our website at www.prestolite.com, or contact our customer service department at:

Leece-Neville Heavy Duty Systems
7585 Empire Drive
Florence, KY 41042

(800) 354-0560
(859) 525-8801
info@prestolite.com

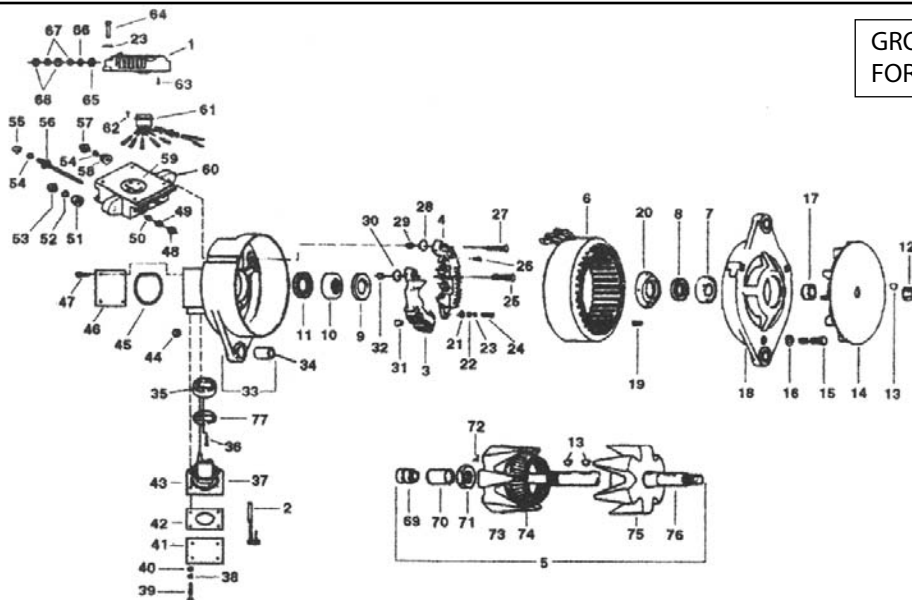

GROUP: 4425-4725JC
FORM: 4627, 10/95

PARTS COMMON

Ref. No.	Part No.	Qty.	Description	Ref. No.	Part No.	Qty.	Description
2	*99516	2	Brush	42	*99518	1	Gasket, Brush Holder
7	*78895	1	DE Bearing, 305	43	99479	1	Brush Holder
8	*79405	1	Seal	44	74732	3	Nut, 10-32 F. Lock
9	*79404	1	Seal	45	*99511	1	"O" Ring
10	*79406	1	SR Bearing, 203	46	99512	1	Cover Plate
11	*79403	1	Seal	47	75348	4	Screw, 10-32 x .5 Hex. Hd. St.
12	76985	1	Nut, 5/8-18 Hex. Fl. Lock	48	31587	3	Nut, 10-32 Hex.
13	6399	1	Key, Woodruff #8	49	2313	3	Nut, 10-32 Hex.
14	79035	1	Fan	50	79469	3	Guard Washer
15	95152	3	Screw, 10-32 x 5.28"	51	73009	1	Nut, Tenz 5/16-18
16	79627	3	Guard Washer	52	3231	1	Lock Washer, 5/16
17	59225	1	Spacer, Fan	53	2364	1	Nut, 5/16-18 Hex. St.
18	*78983	1	Housing, DE	54	2523	4	Lock Washer, 1/4
19	58754	4	Screw, 10-32 x .44 Fl. Hd. St.	55	3395	3	Nut, 1/4-20 Hex.
20	79486	1	Retainer Bearing	56	99513	3	AC Terminal Stud
21	*52066	2	Insulation, Washer	57	2771	1	Nut, Tenz 1/4-20
22	2385	2	Guard Washer, #10	58	58982	1	Nut, Tenz 1/4-20
23	2434	6	Lock Washer, #10	59	*99515	1	Regulator Gasket
24	78337	2	Screw, 10-32 x 75 Pan Hd. St.	60	99478	1	Regulator Holder
25	78997	1	Output Terminal Screw, 5/16"	61	*99481	1	Connector Assembly
26	74543	3	Screw, 6-32 Hex. Hd. S'tap	62	13771	2	Screw, 10-32 x .5 Hex. Hd. St.
27	79313	1	Output Terminal Screw, 1/4"	63	99459	1	Screw, 6-32 x 1/4" Pan Hd.
28	*73545	1	Insulation Bushing	64	99525	4	Screw, 10-32 x 1" Hex. Hd. St.
29	*79070	1	Insulation Bushing	65	*7983	1	Insulation Washer
30	*73546	1	Insulation Bushing	66	5413	1	Flat Washer
31	*73547	2	Insulation Bushing	67	31256	2	Lock Washer, S'proof
32	*79071	1	Insulation Bushing	68	4340	2	Nut, 10-24 Hex.
33	*95279	1	Housing, S.R.E. (See Note 1)	69	71193	1	Slip Ring Assembly
34	*77916	1	Bushing, Slideable	70	79424	1	Inner Race, Bearing
35	99508	1	Brush Holder Adapter	71	30806	1	Nut, 1-14 Hex. St.
36	13747	2	Screw, 6-32 x .62 Rd. Hd. St.	72	78047	1	Insulator, Slot
37	*99514	1	"O" Ring	73	Note 2	1	Rotor Half, S.R.E.
38	2435	4	Lock Washer, #8	75	Note 2	1	Rotor Half, D.E.
39	99524	4	Screw, 8-32 x 1" Hex. Hd. St.	76	79422	1	Shaft, Rotor
40	36912	4	Guard Washer, #8	77	95274	1	Connector Guide
41	99517	1	Brush Cover				

***Suggested Service Parts**

NOTE 1: Slip Ring End (S.R.E.) housing #95279, is shipped with Ref. No. 9 (Seal), Ref. No. 10 (Bearing), Ref. No. 11 (Seal), and Ref. No. 34 (Slideable Bushing).

NOTE 2: Rotor Half replacement is recommended only if accurate balancing and machining equipment is available. Part numbers are available on request from factory.

Important: The information contained in this bulletin is intended for use by trained, professional technicians who have the proper tools equipment, and training to perform the required maintenance described above. This information is NOT intended for 'do-it-yourselfers', and you should not assume that this information applies to your equipment. If you have any questions regarding this information please visit our website at www.prestolite.com, or contact our customer service department at: