

GROUP:	7070AA
FORM:	3937
FILE:	Alternator Parts List Section
DATE:	May, 1978

PRODUCTS COVERED

MODEL	VOLTS	AMPS
7070AA	14	65

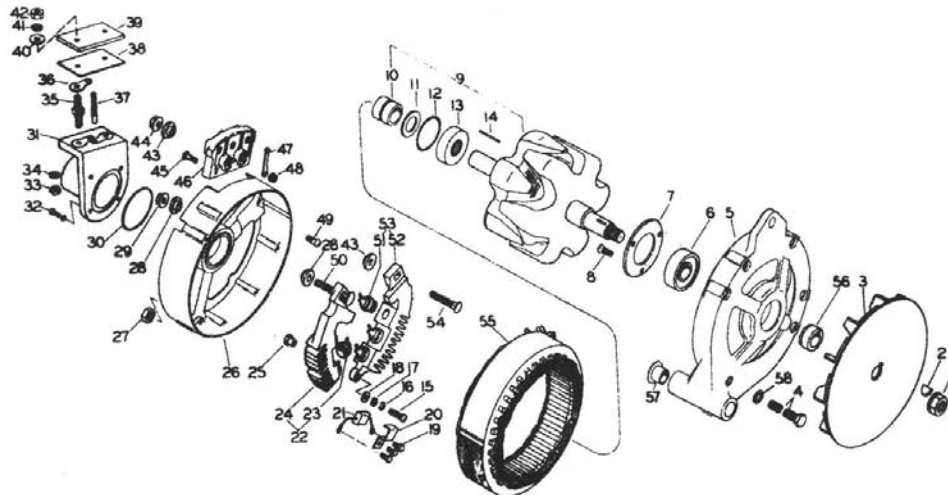

Ref. Part No.	Part No.	Qty	Description	Ref. Part No.	Part No.	Qty	Description
1	74107	1	Nut, Flange Lock	30	57611	1	Ring, Sealing
2	6399	1	Key, No.8 Woodruff	31	*58777	1	Housing, Brush Holder
3	58797	1	Fan Assembly	32	13622	4	Screw, 8-32 x 7/16 Rd. Hd. St.
4	59972	3	Screw, 10-32 x 3-5/8" Hex. Hd.	33	4340	2	Nut, 10-24 Hex. St.
5	*74122	1	Housing, D.E.	34	4534	2	Lockwasher, No.10 S'proof
6	57166	1	Bearing, 304	35	*57613	2	Stud, Terminal
7	59234	1	Retainer, Bearing	36	*57594	2	Jumper
8	58754	4	Screw, 10-32 x 7/16 Fl. Hd. S'tap	37	*28711	2	Brush & Spring Assy.
9	59339	1	Rotor & Slip Ring Assembly	38	73814	1	Gasket
10	*57462	1	Ring Assembly, Slip	39	57615	1	Cover, Terminal
11	57626	1	Washer, Insulation	40	5293	2	Guard Washer
12	57597	1	"O" Ring	41	4534	2	Lockwasher, No. 10 S'proof
13	*28653	1	Bearing, 203	42	32629	2	Nut, 10-32 Hex. St.
14	30300	1	Wedge, Slot	43	*73545	2	Bushing, Insulation
15	4491	2	Screw, 10-32 x 3/4 Rd. Hd. St.	44	59982	1	Nut, Tenz 1/4-20
16	2434	2	Lockwasher, No. 10	45	73659	3	Screw, 10-32 x 1/2 Sq. Hd. St.
17	5291	2	Guard Washer, No. 10	46	73635	1	Insulator
18	13657	2	Washer, Insulation	47	73657	3	Jumper Assembly
19	73543	3	Screw, 6-32 Hex. Hd. S'tap	48	31587	3	Nut, Lock
20	73760	1	Clamp	49	5179	2	Screw, 10-32 x 1/2" Rd. Hd. St.
21	73541	1	Capacitor Assembly	50	*58431	1	Screw, Terminal
22	*71068	1	Rectifier Assembly	51	*73548	1	Rectifier & Lead Assembly
23	*73549	3	Rectifier & Lead Assembly	52	*58437	1	Mount, Rectifier
24	*58436	1	Mount, Rectifier	53	*71067	1	Rectifier Assembly
25	*73547	2	Bushing, Insulation	54	*58432	1	Screw, Terminal
26	71084	1	Housing & "O" Ring Assembly	55	*50040	1	Stator & Terminal Assembly
27	26175	3	Nut, Elastic Stop, No. 10-32	56	59324	1	Spacer, Fan
28	73546	2	Bushing, Insulation	57	99024	1	Insert, Mounting
29	73009	1	Nut, Tenz 5/16-18	58	75451	3	Washer, Belleville

* SUGGESTED SERVICE PARTS

Important: The information contained in this bulletin is intended for use by trained, professional technicians who have the proper tools equipment, and training to perform the required maintenance described above. This information is NOT intended for 'do-it-yourselfers', and you should not assume that this information applies to your equipment. If you have any questions regarding this information please visit our website at www.prestolite.com, or contact our customer service department at:

Leece-Neville Heavy Duty Systems
7585 Empire Drive
Florence, KY 41042

(800) 354-0560
(859) 525-8801
info@prestolite.com