

## SERVICE PARTS LIST

GROUP:	8
FORM:	8HC
FILE:	Alternator Parts List Section
DATE:	August, 1999

MODEL	VOLTS	AMPS
Various See Chart		

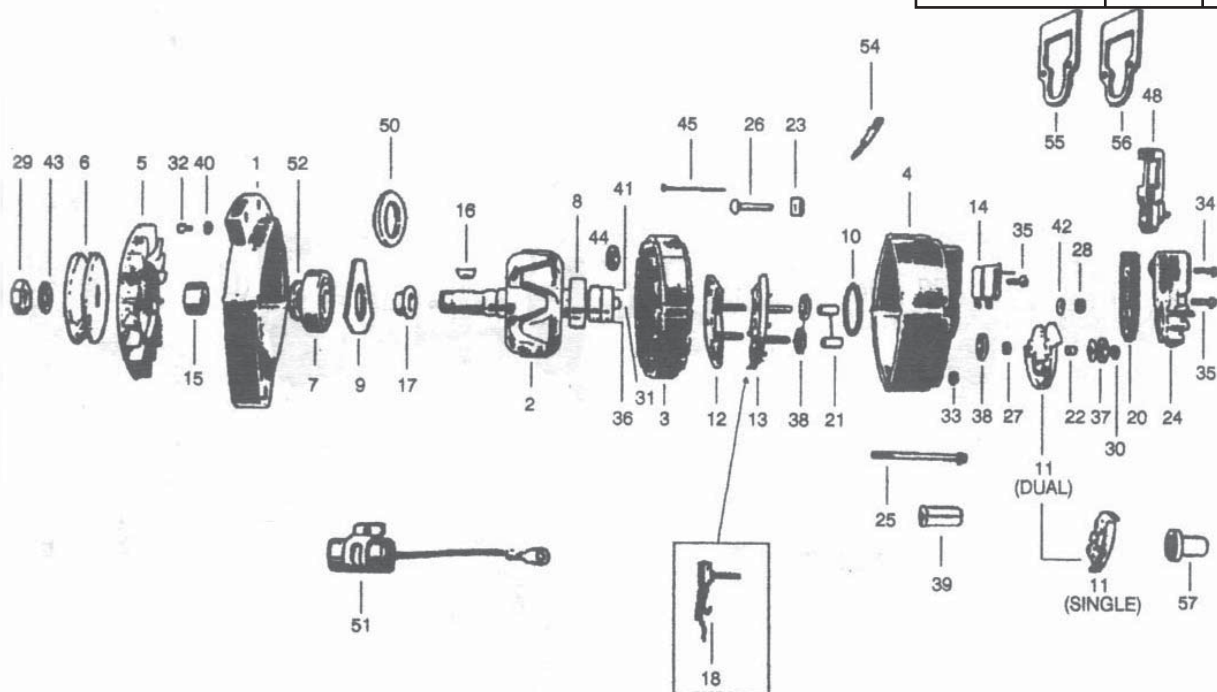

MODEL NO.	SALES NO.	1 HSNG FRONT	2 ROTOR ASSEM	3 STATOR ASSEM	4 HSNG REAR	5 FAN	6 PULLEY	7 FRONT BRNG	8 REAR BRNG	9 FR. BRNG RET.	10 R. BRNG RET.	11 ISOLA. DIODE	12 DIODE RECT. NEG
8HC2001L	110-109	114-44	112-28	113-4	114-68	107-44		111-40	111-21	111-27	111-64	101-30	101-150
8HC2003P	110-114	114-136	112-40	113-16	114-63	107-44		111-40	111-21	111-27	111-64	101-70	101-148
8HC2004F	110-186	114-86	112-21	113-1	114-63	107-44	107-62	111-40	111-21	111-27	111-64	101-30	101-148
8HC2005L		114-44	112-28	113-4	114-68	107-44		111-40	111-21	111-27	111-64	101-30	101-18
8HC2007F		114-86	112-21	113-1	114-63	107-8	107-13	111-40	111-21	111-27	111-64		101-197
8HC2008F		114-86	112-21	113-1	114-63	107-8		111-40	111-21	111-27	111-64	101-30	101-148
8HC2009P	110-205	114-118	112-40	113-16	114-72	107-44		111-40	111-21	111-27	111-64		101-148
8HC2012F	110-208	114-135	112-21	113-1	114-151	107-44		111-40	111-21	111-27	111-64		101-18
8HC2013P	110-209	114-135	112-40	113-16	114-151	107-44		111-40	111-21	111-27	111-64		101-148
8HC2014K	110-210	114-135	112-28	113-19	114-151	107-44		111-40	111-21	111-27	111-64		101-18
8HC2015L	110-212	114-135	112-40	113-9	114-151	107-44		111-40	111-21	111-27	111-64		101-148
8HC2018L	110-230	114-136	112-40	113-9	114-151	107-44		111-40	111-21	111-27	111-64		101-148
8HC2021K	110-267	114-44	112-28	113-19	114-151	107-44		111-40	111-21	111-27	111-64		101-197
8HC2023K	110-284	114-44	112-28	113-19	114-198	107-44		111-40	111-21	111-27	111-64		101-197
8HC2024K	110-312	114-44	112-28	113-19	114-198	107-44		111-40	111-21	111-27	111-64		101-197
8HC2027P	110-404	114-246	112-40	113-16	114-245	107-44		111-40	111-21	111-27	111-64		101-213
8HC3002F	110-193	114-16	112-27	113-5	114-63	107-44		111-40	111-21	111-27	111-64	101-30	101-18
8HC3006F	110-180	114-107	112-27	113-5	114-106	107-44	107-4	111-40	111-21	111-27	111-64		101-197
8HC3010G	110-196	114-86	112-34	113-30	114-151	107-44		111-40	111-21	111-27	111-64		101-18
8HC3017G	110-222	114-136	112-34	113-30	114-151	107-44		111-40	111-21	111-27	111-64		101-18
8HC3022F	110-285	114-44	112-27	113-5	114-151	107-44		111-40	111-21	111-27	111-64		101-197
8HC3025F	110-313	114-44	112-27	113-5	114-151	107-44		111-40	111-21	111-27	111-64		101-197
8HC3026G	110-392	114-232	112-34	113-30	114-151	107-44		111-40	111-21	111-27	111-64		101-209

Important: The information contained in this bulletin is intended for use by trained, professional technicians who have the proper tools, equipment, and training to perform the required maintenance described above. This information is NOT intended for 'do-it-yourselfers', and you should not assume that this information applies to your equipment. If you have any questions regarding this information please visit our website at [www.prestolite.com](http://www.prestolite.com), or contact our technical service department at:

## SERVICE PARTS LIST

GROUP:	8
FORM:	8HC

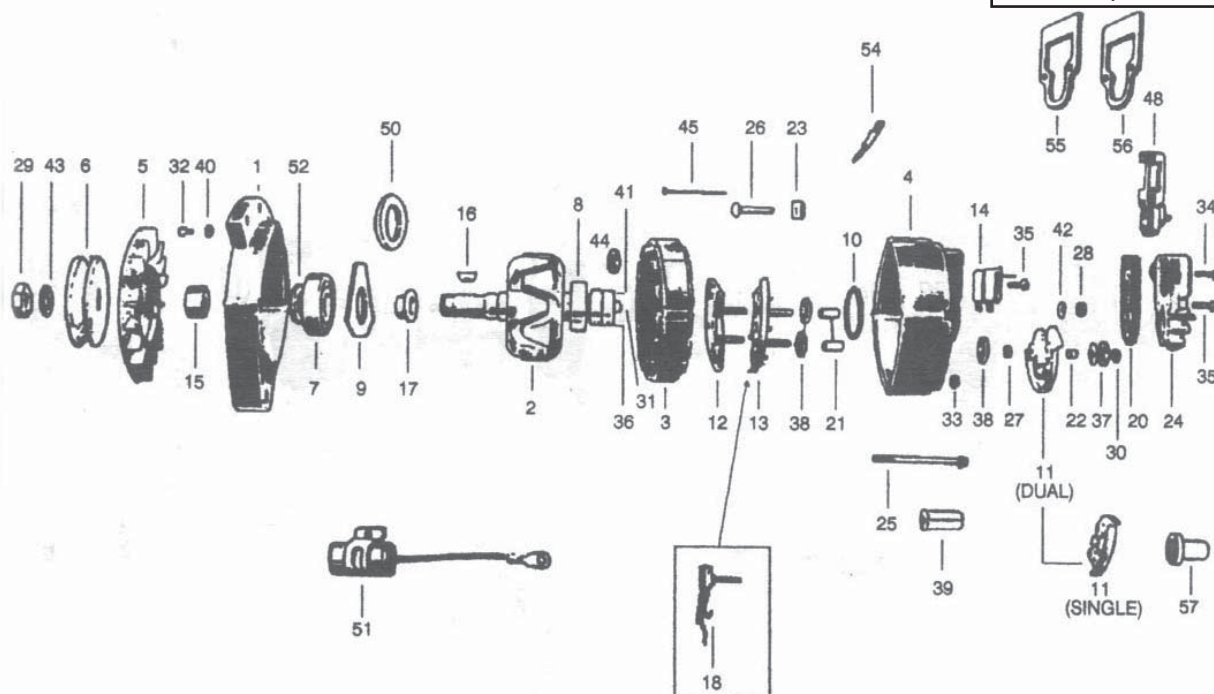

MODEL NO.	SALES NO.	13 DIODE RCT.POS.	14 BRUSH ASSEM	15 FAN SPACER	16 WDRFF KEY	17 SLEEVE SHAFT	18 DIODE TRIO	19 SLIP RING	20 RING GASKET	21 SLEEVE INSUL.	22 SLEEVE INSUL.	23 INSUL. MOLDED	24 VOLT. REG.
8HC2001L	110-109	101-149	103-16	120-147	120-7	120-89		112-22	103-14	115-1	115-2		105-198
8HC2003P	110-114	101-147	103-15	120-147	120-7	120-89		112-22	103-14	115-1			105-181
8HC2004F	110-186	101-46	103-15	120-147	120-7	120-89		112-22	103-14	115-1	115-2	115-7	105-181
8HC2005L		101-50	103-15	120-147	120-7	120-89		112-22	103-14	115-1	115-2		105-197
8HC2007F		101-50	103-15	120-147	120-7	120-89		112-22	103-14	115-1	115-2		105-181
8HC2008F		101-50	103-15	120-147	120-7	120-89		112-22	103-14	115-1	115-2		105-181
8HC2009P	110-205	101-137	103-16	120-147	120-7	120-89		112-22	103-14	115-1		115-7	105-203
8HC2012F	110-208	101-98	103-15	120-147	120-7	120-89	101-130	112-22	103-14	115-21	115-26		105-172
8HC2013P	110-209	101-164	103-15	120-147	120-7	120-89	101-130	112-22	103-14	115-21	115-26		105-172
8HC2014K	110-210	101-98	103-15	120-147	120-7	120-89		112-22	103-14	115-21	115-26		105-172
8HC2015L	110-212	101-164	103-15	120-147	120-7	120-89	101-130	112-22	103-14	115-21	115-26		105-172
8HC2018L	110-230	101-164	103-15	120-147	120-7	120-89	101-130	112-22	103-14	115-21	115-26		105-172
8HC2021K	110-267	101-196	103-12	120-147	120-7	120-89		112-22	103-14	115-1	115-26	115-7	105-224
8HC2023K	110-284	101-196	103-12	120-147	120-7	120-89		112-22	103-14	115-1	115-26	115-7	105-245
8HC2024K	110-312	101-196	103-12	120-147	120-7	120-89		112-22	103-14	115-1	115-26	115-7	105-245
8HC2027P	110-404	101-164	103-46	120-147	120-7	120-89		112-22	103-14	115-21	115-26	115-7	105-200
8HC3002F	110-193	101-46	103-16	120-147	120-7	120-89		112-22	103-14	115-1	115-2	115-7	105-208
8HC3006F	110-180	101-98	103-16	120-147	120-7	120-89	101-130	112-22	103-14	115-1	115-26	115-7	105-179
8HC3010G	110-196	101-98	103-15	120-147	120-7	120-89	101-130	112-22	103-14	115-39	115-26		105-149
8HC3017G	110-222	101-98	103-15	120-257	120-7	120-89	101-130	112-22	103-14	115-21	115-26		105-149
8HC3022F	110-285	101-196	103-12	120-147	120-7	120-89		112-22	103-14	115-39	115-26	115-7	105-247
8HC3025F	110-313	101-196	103-12	120-147	120-7	120-89		112-22	103-14	115-1	115-26	115-7	105-247
8HC3026G	110-392	101-210	103-39	120-257	120-7	120-89	101-130	112-22	103-14	115-21	115-26		105-273

Important: The information contained in this bulletin is intended for use by trained, professional technicians who have the proper tools, equipment, and training to perform the required maintenance described above. This information is NOT intended for 'do-it-yourselfers', and you should not assume that this information applies to your equipment. If you have any questions regarding this information please visit our website at [www.prestolite.com](http://www.prestolite.com) , or contact our technical service department at:



GROUP: 8  
FORM: 8HC

KEY NO.	SALES NO.	DESCRIPTION	8HC2001L	8HC2003P	8HC2004F	8HC2005L	8HC2007F	8HC2008F	8HC2009P	8HC2012F	8HC2013P	8HC2014K	8HC2015L	8HC2018L	8HC2021	8HC2023K	8HC2024K	8HC2027P	8HC3002F	8HC3006F	8HC3010G	8HC3017G	8HC3022F	8HC3025F	8HC3026G
<b>BOLTS</b>																									
25	120-1	THROUGH, 10-32 x 2-55/64"			4		4	4		4															
25	120-143	THROUGH, 10-32 x 3-1/8"									4				4	4	4		4	4			4	4	
25	120-86	THROUGH, 10-32 x 3-5/16"	4	4		4			4		4		4	4				4			4	4		4	
26	120-93	CARRIAGE, 10-24 x 1-1/2"			1			1	1							2	2	2	1	1	1		2	2	
<b>NUTS</b>																									
27	120-34	HEX, 10-24 IRIDITE	4	4	4	4	3	4	2	4	4	4	4	4	3	3	3	2	4	3	4	4	3	3	4
28	120-160	HEX, 1/4-20 IRIDITE	2	2	2	2	2	2	4	2	2	2	2	2	2	2	2	4	2	4	2	2	2	2	2
29	120-136	HEX PULLEY, 5/8-18 CAD	1	1	1	1	1	1	1	1	1	1	1	1	1	1	1	1	1	1	1	1	1	1	1
30	120-148	HEX LOCK, 10-24 IRIDITE	4	4	4	4	3	4	2	3	3	3	3	3	3	3	3	4	4	2	3	3	3	3	3
<b>SCREWS</b>																									
31	120-56	CAP, 10-32 x 5/8"	1	1	1	1	1	1	1	1	1	1	1	1	1	1	1		1	1	1	1	1	1	1
32	120-141	MACHINE, 8-32 x 3/8" IRIDITE	3	3	3	3	3	3	3	3	3	3	3	3	3	3	3	3	3	3	3	3	3	3	3
34	120-102	TAPPING, 8-32 x 1/2" IRIDITE	2	2	2	2	2	2	2	2	2	2	2	2	2	2	2	2	2	2	2	2	2	2	2
35	120-117	TAPPING, 8-32 x 3/4" IRIDITE	4	4	4	4	4	4	4	4	4	4	4	4	4	4	4	4	4	4	4	4	4	4	4
<b>WASHERS</b>																									
51	115-51	INSULATOR, NO. 10 x 9/16" OD	1	1	1	1	1	1	1	1	1	1	1	1	1	1	1		1	1	1	1	1	1	1
52	115-20	INSULATOR, 5/16" STUD x 13/16" OD	4	4	4	4	3	4	2		4	4			3	3	3	4	4	3	4	4	3	3	4
53	115-10	INSULATOR, 1/4" STUD x 3/4" OD								4	4		4												
54	120-120	FLAT METAL, NO. 10 STUD x 7/16" OD	1	1	1	1		1										2	1					2	
55	120-189	FLAT METAL, 5/16" STUD x 5/8" OD	4	4	4	4	2	4	4	4	4	4	4	4	4	4	4	4	4	4	2	2	4	4	2
57	120-129	FLAT METAL, 5/8" STUD x 1-1/4" OD					2		4	2	2	2	2	2	2	2	2	2	3	2	2	2	2	2	2
58	120-113	SPLITLOCK, 1/4"	3	3	3	3	3	3	3	3	3	3	3	3	3	3	3	3	3	3	3	3	3	3	3
60	120-26	SPLITLOCK, 5/16"	4	4	4	4	3	4	2	4	4	4	4	4	3	3	3	2	4	3	4	4	3	3	4
69	120-109	FLAT METAL, 1/4" STUD	1	1	1	1	1	1	2	1	1	1	1	1	1	1	1	1	1	1	1	1	1	1	1
<b>MISC.</b>																									
45	120-227	STRAP, LOCKING	2	2	2	2	2	2	2	2	2	2	2	2	2	2	2	2	2	2	2	2	2	2	2
48	114-105	COVER, REAR HOUSING																		1					
57	120-287	INSULATOR CAP														2	2	2					2	2	
50	111-18	WASHER, BEARING SEAL														1	1	1					1	1	
51	102-4	CAPACITOR, 8 mFd																							
52	111-76	OIL SEAL, FELT	1	1	1	1	1	1	1	1	1	1	1	1	1	1	1	1	1	1	1	1	1	1	1
54	116-58	CABLE AC TAP														2	2	2	1		1		2	2	
55	114-178	PLATE ADAPTOR														1	1	1					1	1	
56	103-49	GASKET														1	1	1					1	1	
51	102-26	CAPACITOR, .5 mFd								1	1	1	1	1					1						
39	120-352	BUSHING, MTG FOOT																	1						

Important: The information contained in this bulletin is intended for use by trained, professional technicians who have the proper tools, equipment, and training to perform the required maintenance described above. This information is NOT intended for 'do-it-yourselfers', and you should not assume that this information applies to your equipment. If you have any questions regarding this information please visit our website at [www.prestolite.com](http://www.prestolite.com), or contact our technical service department at: